

5

Sitali

Heat Recovery
Ventilation unit

 **OLIMPIA
SPLENDID**
HOME OF COMFORT

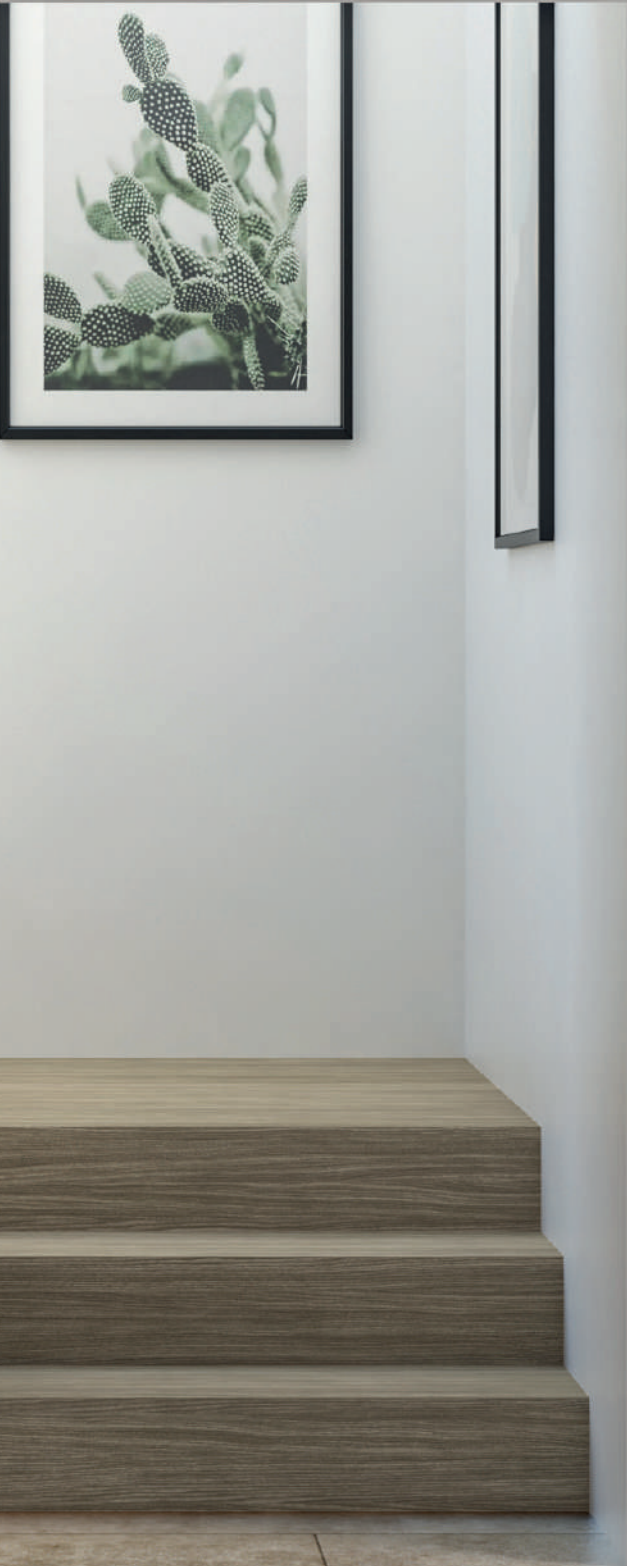



Indoor air quality

The importance of controlled outdoor air intake.

What are the benefits for indoor comfort?

The most respected exponents of the scientific community agree on the importance of the introduction of outdoor air indoors, to increase the quality of indoor air. The greater the quantity of external air introduced into closed environments, the lower the concentration of pollutants and pathogens.

Air renewal through open windows is not always possible (for example in summer and winter) or sufficient: in fact, the quantity of incoming air cannot be controlled, nor can its uniform distribution. Where Heat Recovery Ventilation systems are present, experts recommend continuous operation (7 days a week and 24 hours a day) and maximising the air change rate as much as possible.



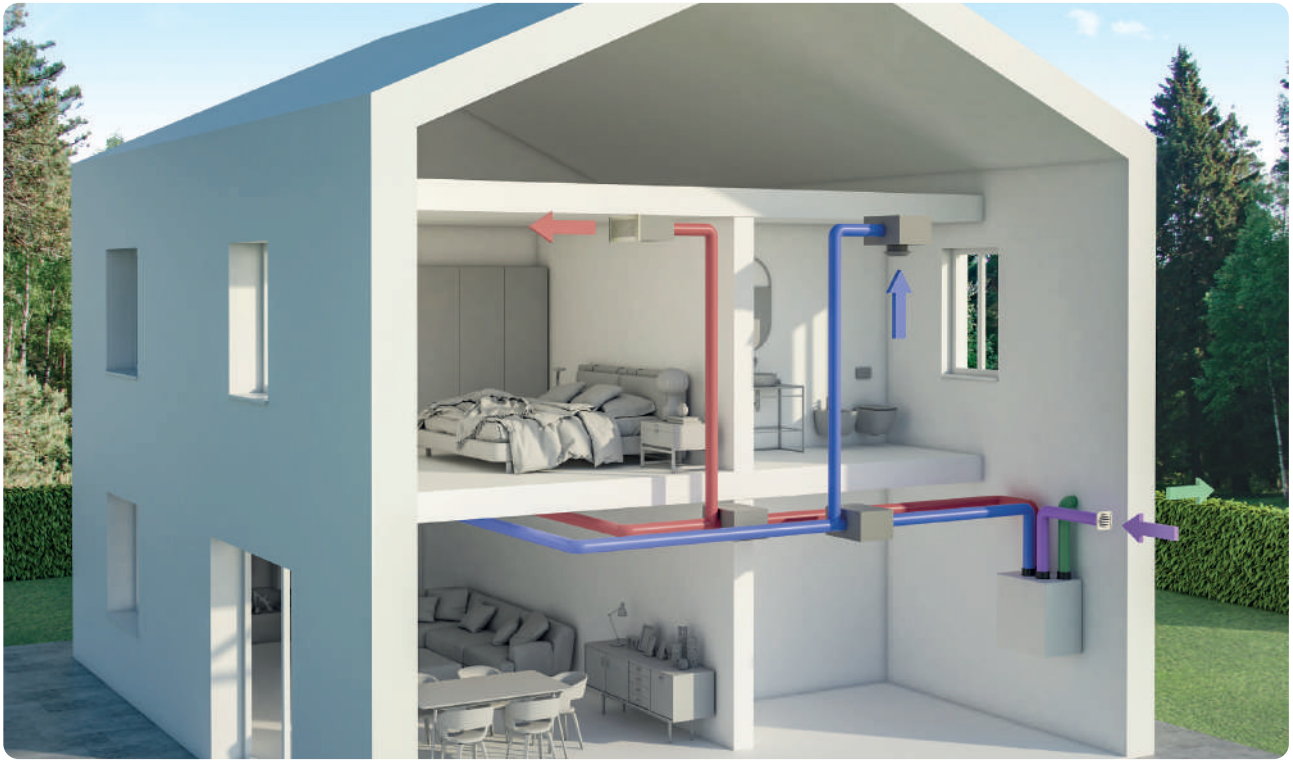

Precise and centralised systems

Diversified solutions for each project.

High efficiency, high comfort



To meet the needs of every room, Olimpia Splendid's Sitali range includes both decentralised and centralised units. Recommended for existing buildings, ad hoc solutions do not require any air distribution system or invasive installation work. For buildings where it is possible to design and implement a distribution system complete with ducts and terminals, however, the installation of centralised units is recommended.

All the solutions for ducted systems include a PPE structure with sheet metal finish and plastic fittings. They are fitted with high-performance, energy-saving EC brushless motors. The ducted machines are fitted with G4 filters (ISO Coarse 60%) to protect the exchanger and, for some sizes, it is possible to use F7 filters (ISO ePM1 60%) for improved intake air filtering.

Thanks to the heat recovery unit, it is possible to transfer the heat of the air extracted from inside the rooms to the fresh air supplied from the outside, limiting the activation of the heating system and improving the building's energy performance.



Heat Recovery Ventilation unit

			FLOW RATE	TYPE	TECHNOLOGY	INSTALLATION
	Sitali SFE 100 [S1]	Sitali SFE 100 S1 [99231]	102 m³/h	punctual	extraction	vertical
	Sitali SF 150 [S1]	Sitali SF 150 S1 [99299]	60 m³/h	punctual	push&pull heat recovery	vertical
	Sitali DF 100 [S1]	Sitali DF 100 S1 [99188]	97 m³/h	punctual	cross-flow heat recovery	vertical

NEW

NOMENCLATURE FOR ZONE UNITS

- Position 1: line name.
- Position 2: flow (SF = single flow; DF = double flow).
- Position 3: type (E = extractor).
- Position 4: hole diameter (mm).
- Position 5: series.

FLOW RATE	TYPE	TECHNOLOGY	INSTALLATION
-----------	------	------------	--------------



Sitali CX 120

Sitali CXRA 120
[99250]

91 m³/h

ducted

cross-flow heat recovery

vertical
horizontal



Sitali CX 180

Sitali CXOA 180
[99248]

177 m³/h

ducted

cross-flow heat recovery

horizontal

Sitali CXOM 180
[99247]

177 m³/h

ducted

cross-flow heat recovery

horizontal



Sitali CX 280 [S1]

Sitali CXVM 280 S1
[99204]

270 m³/h

ducted

cross-flow heat recovery

vertical

Sitali CXVA 280 S1
[99205]

270 m³/h

ducted

cross-flow heat recovery

vertical



Sitali CX 400

Sitali CXVA 400
[99244]

363 m³/h

ducted

cross-flow heat recovery

vertical



Sitali CX 550

Sitali CXVA 550
[99243]

520 m³/h

ducted

cross-flow heat recovery

vertical

NOMENCLATURE FOR DUCTED UNITS

- Position 1: line name.
- Position 2: type (C = ducted).
- Position 3: airflow (X = cross-flow).
- Position 4: installation (R = reversible; V = vertical; O = horizontal).
- Position 5: controls (A = automatic; M = manual).
- Position 6: air flow rate (m³/h).
- Position 7: series.

Key

STANDARD CONTROLS



Wired wall control



Possibility of connection to SiOS Control home automation system (via dry contact)



Possibility of connection to external home automation system (via dry contact)



Remote control

FUNCTIONS



Antifrost

It limits the intake of air from the outside, preventing the heat exchanger from freezing.



Humidity Sensor

Increases air exchange, in case of high indoor humidity levels.



Bypass

Reduces heat exchange in summer, when climatic conditions are less than favourable.



Silent Mode

Reduces the noise of the product, for greater acoustic comfort.



Holiday

Sets the unit to low speed, when away from home.



Turbo

Maximises extraction, to facilitate air exchange in the shortest time possible.



Filter Cleaning Signal

Shows the filter replacement and cleaning alarm.



UNICO

NEXVA

SHERPA

BIZ

SITALI

SIOS CONTROL

DOLCECLIMA

AQUARIA

HEAT RECOVERY VENTILATION UNIT

SITALI SFE 100

[S1]



Flow rate	102 m³/h
Type	punctual
Technology	extraction
Installation	vertical



Automatic detection of humidity

The unit is equipped with a humidity detection probe that operates in automatic mode (humidistat function that can be activated via dip switch). When there is a sudden increase in humidity and/or when the humidity value exceeds 65%, the unit operates at the intermediate speed. The speed decreases only when the humidity stabilizes for a fixed time of 5 minutes.



-  **Air Replacement**
-  **Humidity Sensor**
-  **Silent Mode**
-  **Turbo**

LAYOUT

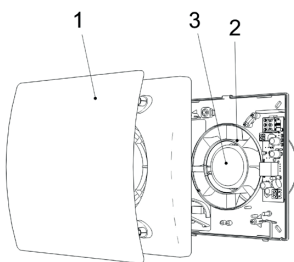

1. High-quality ABS front cover, easily removable for cleaning
2. High-efficiency aerodynamic fan
3. EC brushless motor with thermal protection (ideal for cold climates)
 - Built-in humidity sensor

DIMENSIONS AND WEIGHT

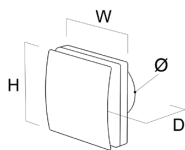

		100
W	mm	164
H	mm	164
D	mm	116
Ø	mm	100
WEIGHT	kg	0,6

COMPATIBLE ACCESSORIES

EXTERNAL DISTRIBUTION	B0838	External grille
	B0837	Telescopic pipe

TECHNICAL DATA

		Sitali SFE 100 S1
Product code		99231
Hole diameter	mm	100 (110 with telescopic tube)
Air flow rate (min/max)	m ³ /h	17/102
Absorption (min/max)	W	0,9/4,5
Sound pressure (min/max) (1)	(1) dB(A)	9/37
Room temperature (max)	°C	40
Degree of protection (wall-mounted installation)		IPX4
Weight	kg	0,6
Treated area (2)	(2) mq	8 m ²

(1) sound pressure level at 3m in free field

(2) Maximum treated area for civil dwellings (regulatory reference UNI 10339:1995) considering 90 m³/h as max flow rate, 10 Pa prevalence and a room height of 2.7 m. 220-240 V ~ 50-60Hz aeraulic performance measured according to ISO 5801 at 230V 50Hz, air density 1.2 Kg/m³ - data measured in TÜV Rheinland accredited laboratory

HEAT RECOVERY VENTILATION UNIT

SITALI SF 150

[S1]

Flow rate	60 m³/h
Type	punctual
Technology	push&pull heat recovery
Installation	vertical



Single alternating flow (push & pull)

The inlet and outlet channel is the same, so the device operates with alternating cycles of inlet and outlet.

Smart operation

Thanks to the temperature sensing probe, the airflow reversal time is self-adjusting to enable the best indoor comfort.



- Air Replacement**
- Filter Cleaning Signal**
- Humidity Sensor**
- Silent Mode**
- Turbo**

LAYOUT

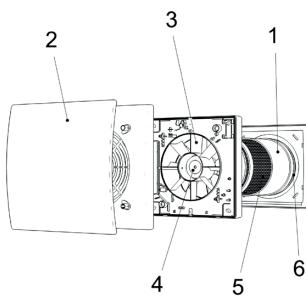

1. Telescopic pipe adaptable to the wall thickness
2. High-quality ABS front cover, easily removable for cleaning (quick release via magnets)
3. High-efficiency aerodynamic fan
4. EC brushless motor with thermal protection (ideal for cold climates)
5. Regenerative heat exchanger with washable ceramic pack
6. Easily removable and washable anti-dust filter
 - Built-in humidity sensor
 - Temperature probe

DIMENSIONS AND WEIGHT

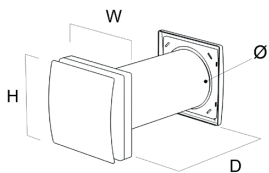

		150
W	mm	218
H	mm	218
D	mm	300 570
Ø	mm	150
WEIGHT	kg	5,5

COMPATIBLE ACCESSORIES

EXTERNAL DISTRIBUTION	B1119	Terminal unit 150 Silent

TECHNICAL DATA

Product code			Sitali SF 150 S1
Hole diameter	mm		99299
Energy class (1)	(1)		160
Air flow rate	m ³ /h		A
Sound pressure taken in + radiated Lp (A) (2)	(2)		60/50/40/30/20
Absorption	W		29/24/20/14/10
Thermal efficiency (max)			6/4,5/3,5/2,5/2
Room temperature (max)	°C		82%
Weight	kg		-20°C +50°C
Degree of protection			5,5
Treated area (3)	(3)	mq	IPX4
			20

(1) Energy efficiency classes refer to a range between A+ and G.

(2) sound pressure level at 3m in free field

(3) Maximum treated area for civil dwellings (regulatory reference UNI 10339:1995) considering 30 m³/h as the maximum flow rate, being of alternate flow. 220-240 V ~ 50-60Hz aeraulic performance measured according to ISO 5801 at 230V 50Hz, air density 1.2 Kg/m³ - data measured in TÜV Rheinland accredited laboratory

HEAT RECOVERY VENTILATION UNIT

SITALI DF 100

[S1]



Flow rate	97 m³/h
Type	punctual
Technology	cross-flow heat recovery
Installation	vertical



Dual-flow heat recovery unit

Heat from the air extracted from inside the rooms is transferred to the fresh air supplied from outside, reducing the activation of the heating system and improving the building's energy performance.

Service continuity and improved air quality

It uses two fans to extract stale indoor air and supply fresh outdoor air, avoiding interruptions and improving the purification of micro-dusts and indoor pollutants, thanks to the absence of air bypass between supply and exhaust.



- Air Replacement**
- Filter Cleaning Signal**
- Humidity Sensor**
- Turbo Mode**

LAYOUT

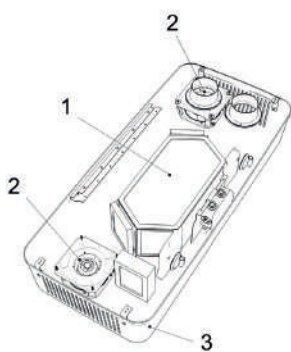

1. Dual-flow heat exchanger
2. Fan with EC Brushless Electric Motor
3. Plastic shell
 - Built-in humidity sensor

DIMENSIONS AND WEIGHT

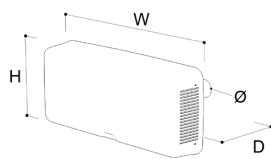

		100
W	mm	1060
H	mm	475
D	mm	213
Ø	mm	100
WEIGHT	kg	12,5

SUPPLY BENDS

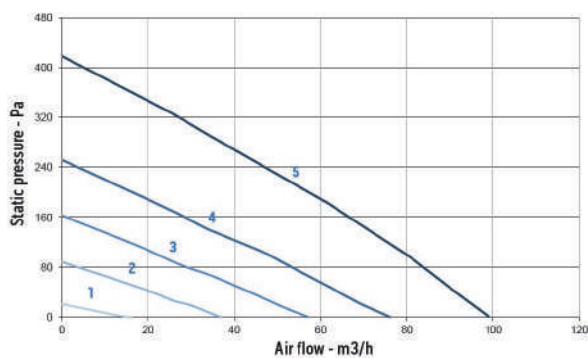

	Speed %	W max	m³/h max
1	20	7	16
2	40	12	37
3	60	22	57
4	80	37	76
5	100	58	97

Input curves in accordance with European Regulation 1253/2014 (ErP)

COMPATIBLE ACCESSORIES

CONTROLS	EXTERNAL DISTRIBUTION
B1061 Control-S 2 recessed modules	B0837 Telescopic pipe
B1062 Control-S 3 recessed modules	B0838 External grille
B1063 Wall-mounted control	

TECHNICAL DATA

NEW

		Sitali DF 100 S1
Product code		99188
Hole diameter	mm	100
Maximum flow rate @100 Pa	m3/h	97
Electrical power consumption (at the maximum flow rate)	W	58
SEC class (local demand control) (1)	(1)	A
SEC class (manual control - No demand control ventilation) (1)	(1)	B
Thermal efficiency	%	87
Reference flow rate	m3/h	97
Reference pressure difference	Pa	10
Specific power consumption (SPI)	W/m3/h	0.515
Sound power level (LWA)	dB(A)	56
Electrical power supply		220-240V~/50-60Hz
IP protection rating		IPX4
Sound pressure @3m (2)	(2) dB(A)	29
Room temperature (max)	°C	+40

(1) Energy efficiency classes refer to a range between A+ and G.
 (2) Sound pressure level at 3 m in free field.

HEAT RECOVERY VENTILATION UNIT

SITALI CX 120



Flow rate	91 m³/h
Type	ducted
Technology	cross-flow heat recovery
Installation	vertical horizontal



Installation versatility

The small footprint makes the unit easy to install in any room, either vertically on a wall or horizontally on a ceiling or counter-ceiling. The unit is also supplied pre-wired to make electrical connection easier.

Dual-flow heat recovery unit

Heat from the air extracted from inside the rooms is transferred to the fresh air supplied from outside, reducing the activation of the heating system and improving the building's energy performance.



- Air Replacement**
- Antifrost**
- Holiday**
- Filter Cleaning Signal**
- Silent Mode**
- Turbo**

LAYOUT

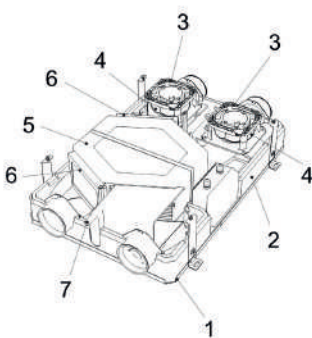

1. External panel in galvanised and pre-painted steel RAL 9010
2. Expanded polypropylene structure to reduce thermal bridges and sound emission, while ensuring maximum airtightness
3. Energy-efficient external rotor EC motors, equipped with thermal protection and mounted on ball bearings to ensure long life
4. Centrifugal-type fan with dynamically balanced backward-curved blades, coupled to the motor
5. High-efficiency cross-flow, counter-current heat exchanger
6. ISO Coarse 0% (G4) filters, removable from outside (no need to remove the access panel for maintenance)
7. Integrated condensate drain (winter only)

DIMENSIONS AND WEIGHT

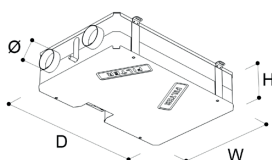

		120
W	mm	559
H	mm	171
D	mm	741
Ø	mm	97
WEIGHT	kg	11,5

SUPPLY BENDS

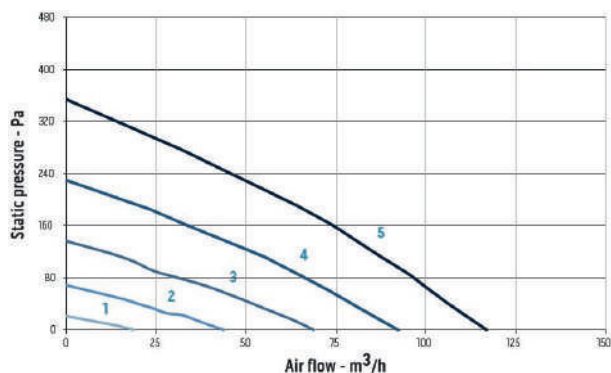

	Speed %	W max	m³/h max
1	20	9	22
2	40	13	48
3	60	20	71
4	80	32	96
5	100	56	114

Input curves in accordance with European Regulation 1253/2014 (ErP)

COMPATIBLE ACCESSORIES

EXTERNAL DISTRIBUTION	EXTERNAL DISTRIBUTION		
	B1065	Ø100mm ABS external grille	
	B1066	Ø125mm ABS external grille	
	B1068	Flex ALU ISO Ø127mm	
	B1074	Ø125mm wall passage	
	B1103	Ø100mm telescopic pipe	
	B1104	Ø125mm telescopic pipe	
	B1110	EPE pipe DN125 L=2m	
	B1111	EPE 90 bend DN125	
	B1112	EPE coupling DN125	
	B1113	EPE collar DN125	
	INTERNAL DISTRIBUTION	INTERNAL DISTRIBUTION	
		B1058	E-I design vent Ø80mm
B1055		E-I design vent Ø100mm	
B1056		E-I design vent Ø125mm	
B1057		E-I design vent Ø150mm	
B1070		FT-White grille 200x100mm	

INTERNAL DISTRIBUTION	INTERNAL DISTRIBUTION	
	B1072	FT-White grille 300x100mm
	B1071	FT-Metal grille 200x100mm
	B1073	FT-Metal grille 300x100mm
	B1059	Flex HDPE 75/63
	B1054	FLEX HDPE 75/63 90° adaptor
	B1076	Blue HDPE 75/63 FLEX hooks
	B1077	Red HDPE 75/63 FLEX hooks
	B1078	FLEX HDPE 75/63 90° bend
	B1087	FLEX HDPE 75/63 coupling
	B1088	O-Ring FLEX HDPE 75/63
	B1095	Plenum P Ø125mm - 4 outlets (for Flex HDPE)
	B1096	Plenum P Ø125mm - 6 outlets (for Flex HDPE)
	B1094	Plenum P Ø125mm - 10 outlets (for Flex HDPE)
	B1092	Plenum L 200x100mm - 1 coupling (for Flex HDPE)
	B1093	Plenum L 300x100mm - 2 couplings (for Flex HDPE)

INTERNAL DISTRIBUTION	INTERNAL DISTRIBUTION	
	B1101	Plenum P 200x100mm - 1 coupling (for Flex HDPE)
	B1102	Plenum P 300x100mm - 2 couplings (for Flex HDPE)
	B1091	Plenum LCS 200x100mm - 1 coupling (for Flex HDPE)
	B1089	Plenum L 140x140mm - 1 coupling (for Flex HDPE)
	B1090	Plenum L 200x200mm - 2 couplings (for Flex HDPE)
	B1097	Plenum P 140x140mm - 1 coupling (for Flex HDPE)
	B1100	Plenum P 200x200mm - 2 couplings (for Flex HDPE)
	B1106	CAL80 damper
	B1107	METAL EST 125 valve

FILTRATION	FILTRATION	
	B1108	PP EST-MM 125 valve
	B1109	METAL IMM 125 valve

B1060	F7 filter box
B1079	F7 filter
B1080	G4 filter

TECHNICAL DATA

		Sitali CXRA 120
Product code		99250
EAN code		8021183992502
Hole diameter	mm	97
Maximum flow rate @100 Pa	m³/h	91
Electrical power consumption (at the maximum flow rate)	W	58
SEC class (local demand control) (1)	(1)	A
SEC class (central demand control) (1)	(1)	A
SEC class (manual control - No demand control ventilation) (1)	(1)	B
Thermal efficiency	%	82
Reference flow rate	m³/h	64
Reference pressure difference	Pa	50
Specific power consumption (SPI)	W/m³/h	0.391
Sound power level (LWA)	dB(A)	50
Electrical power supply		220-240V~/50-60Hz
IP protection rating		IPX4
Sound pressure @3m (2)	(2) dB(A)	18
Room temperature (max)	°C	+40

(1) Energy efficiency classes refer to a range between A+ and G.

(2) Sound pressure level at 3 m in free field, of the casing, speed 40%, reported for comparison purposes only.

HEAT RECOVERY VENTILATION UNIT

SITALI CX 180



Flow rate	177 m³/h
Type	ducted
Technology	cross-flow heat recovery
Installation	horizontal



Integrated physical bypass

It allows for the heat exchanger to be partially bypassed during the summer, offering the possibility of using fresh outdoor air to cool the rooms ("free cooling").

Dual-flow heat recovery unit

Heat from the air extracted from inside the rooms is transferred to the fresh air supplied from outside, reducing the activation of the heating system and improving the building's energy performance.



-  **Air Replacement**
-  **Antifrost**
-  **Bypass**
-  **Holiday**
-  **Filter Cleaning Signal**
-  **Silent Mode**
-  **Turbo**

LAYOUT

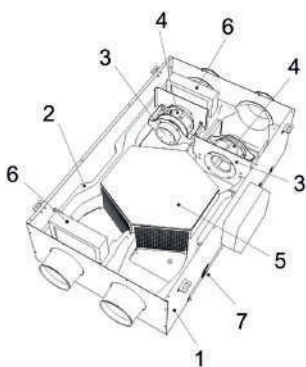

1. External panel in galvanised and pre-painted steel RAL 9010
2. Expanded polypropylene structure to reduce thermal bridges and sound emission, while ensuring maximum airtightness
3. Energy-efficient external rotor EC motors, equipped with thermal protection and mounted on ball bearings to ensure long life
4. Centrifugal-type fan with dynamically balanced backward-curved blades, coupled to the motor
5. High-efficiency cross-flow, counter-current heat exchanger
6. ISO Coarse 0% (G4) filters, removable from outside (no need to remove the access panel for maintenance)
7. Dual condensate drain, usable according to climatic requirements

DIMENSIONS AND WEIGHT

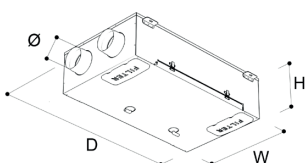

		CXOA 180	CXOM 180
W	mm	574	574
H	mm	270	270
D	mm	1037	1037
Ø	mm	125	125
WEIGHT	kg	20	20

SUPPLY BENDS

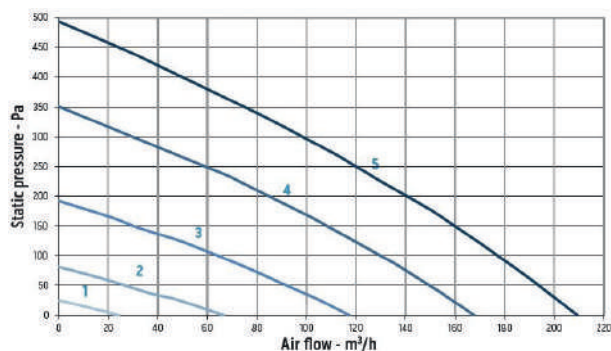

SITALI CXOA 180

	Speed %	W max	m³/h max
1	20	10	24
2	40	18	67
3	60	36	117
4	80	77	178
5	100	105	209

Input curves in accordance with European Regulation 1253/2014 (ErP)

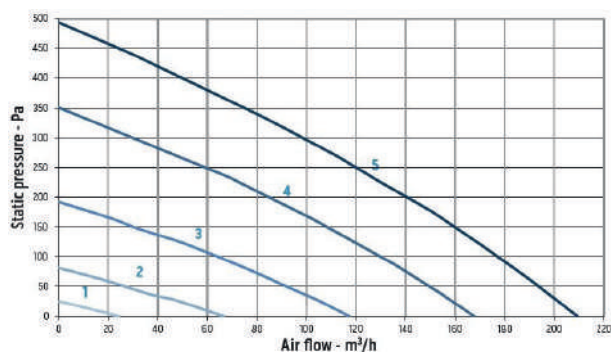

SITALI CXOM 180

	Speed %	W max	m³/h max
1	20	10	24
2	40	18	67
3	53	28	100
4	60	36	117
5	70	47	139
6	80	68	168
7	100	105	209

Input curves in accordance with European Regulation 1253/2014 (ErP)

COMPATIBLE ACCESSORIES

CONTROLS	B1061	Control-S 2 recessed modules	
	B1062	Control-S 3 recessed modules	
	B1063	Wall-mounted control	
EXTERNAL DISTRIBUTION	B1066	Ø125mm ABS external grille	
	B1068	Flex ALU ISD Ø127mm	
	B1074	Ø125mm wall passage	
	B1104	Ø125mm telescopic pipe	
	B1110	EPE pipe DN125 L=2m	
	B1111	EPE 90 bend DN125	
	B1112	EPE coupling DN125	
	B1113	EPE collar DN125	
	INTERNAL DISTRIBUTION	B1058	E-I design vent Ø80mm
		B1055	E-I design vent Ø100mm
B1056		E-I design vent Ø125mm	
B1057		E-I design vent Ø150mm	

INTERNAL DISTRIBUTION	B1070	FT-White grille 200x100mm
	B1072	FT-White grille 300x100mm
	B1071	FT-Metal grille 200x100mm
	B1073	FT-Metal grille 300x100mm
	B1059	Flex HDPE 75/63
	B1054	FLEX HDPE 75/63 90° adaptor
	B1076	Blue HDPE 75/63 FLEX hooks
	B1077	Red HDPE 75/63 FLEX hooks
	B1078	FLEX HDPE 75/63 90° bend
	B1087	FLEX HDPE 75/63 coupling
	B1088	O-Ring FLEX HDPE 75/63
	B1095	Plenum P Ø125mm - 4 outlets (for Flex HDPE)
	B1096	Plenum P Ø125mm - 6 outlets (for Flex HDPE)
	B1094	Plenum P Ø125mm - 10 outlets (for Flex HDPE)
	B1092	Plenum L 200x100mm - 1 coupling (for Flex HDPE)

INTERNAL DISTRIBUTION	B1093	Plenum L 300x100mm - 2 couplings (for Flex HDPE)
	B1101	Plenum P 200x100mm - 1 coupling (for Flex HDPE)
	B1102	Plenum P 300x100mm - 2 couplings (for Flex HDPE)
	B1091	Plenum LCS 200x100mm - 1 coupling (for Flex HDPE)
	B1089	Plenum L 140x140mm - 1 coupling (for Flex HDPE)
	B1090	Plenum P 200x200mm - 2 couplings (for Flex HDPE)
	B1097	Plenum P 140x140mm - 1 coupling (for Flex HDPE)
	B1100	Plenum P 200x200mm - 2 couplings (for Flex HDPE)
	B1106	CAL80 damper
	B1107	METAL EST 125 valve
FILTRATION	B1108	PP EST-MM 125 valve
	B1109	METAL IMM 125 valve
	B1060	F7 filter box
	B1081	F7 filter
	B1082	G4 filter

TECHNICAL DATA

		Sitali CXOA 180	Sitali CXOM 180
Product code		99248	99247
EAN code		8021183992489	8021183992472
Hole diameter	mm	125	125
Maximum flow rate @100 Pa	m³/h	177	177
Electrical power consumption (at the maximum flow rate)	W	105	105
SEC class (local demand control) (1)	(1)	A	A
SEC class (central demand control) (1)	(1)	A	A
SEC class (manual control - No demand control ventilation) (1)	(1)	B	B
Thermal efficiency	%	82	82
Reference flow rate	m³/h	124	124
Reference pressure difference	Pa	50	50
Specific power consumption (SPI)	W/m³/h	0,412	0,412
Sound power level (LWA)	dB(A)	50	50
Electrical power supply		220-240V /50-60Hz	220-240V /50-60Hz
IP protection rating		IPX4	IPX4
Sound pressure @3m (2)	(2) dB(A)	21	21
Room temperature (max)	°C	+40	+40

(1) Energy efficiency classes refer to a range between A+ and G.

(2) Sound pressure level at 3 m in free field, of the casing, speed 40%, reported for comparison purposes only.

HEAT RECOVERY VENTILATION UNIT

SITALI CX 280

[S1]

Flow rate	270 m³/h
Type	ducted
Technology	cross-flow heat recovery
Installation	vertical



Integrated physical bypass

It allows for the heat exchanger to be partially bypassed during the summer, offering the possibility of using fresh outdoor air to cool the rooms ("free cooling").

Dual-flow heat recovery unit

Heat from the air extracted from inside the rooms is transferred to the fresh air supplied from outside, reducing the activation of the heating system and improving the building's energy performance.



- Air Replacement**
- Antifrost**
- Bypass**
- Holiday**
- Filter Cleaning Signal**
- Silent Mode**
- Turbo**

LAYOUT

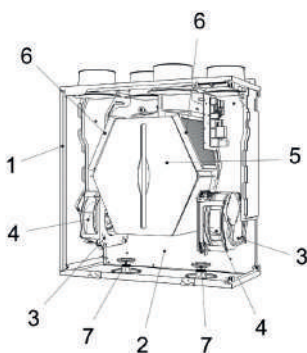

1. External panel in galvanised and pre-painted steel RAL 9010
2. Expanded polypropylene structure to reduce thermal bridges and sound emission, while ensuring maximum airtightness
3. Energy-efficient external rotor EC motors, equipped with thermal protection and mounted on ball bearings to ensure long life
4. Centrifugal-type fan with dynamically balanced backward-curved blades, coupled to the motor
5. High-efficiency cross-flow, counter-current heat exchanger
6. ISO Coarse 0% (G4) filters, removable from outside (no need to remove the access panel for maintenance)
7. Dual condensate drain, usable according to climatic requirements

DIMENSIONS AND WEIGHT

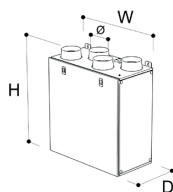

		CXVM 280	CXVA 280
W	mm	592	592
H	mm	665	665
D	mm	298	298
Ø	mm	125	125
WEIGHT	kg	23,0	21,4

SUPPLY BENDS

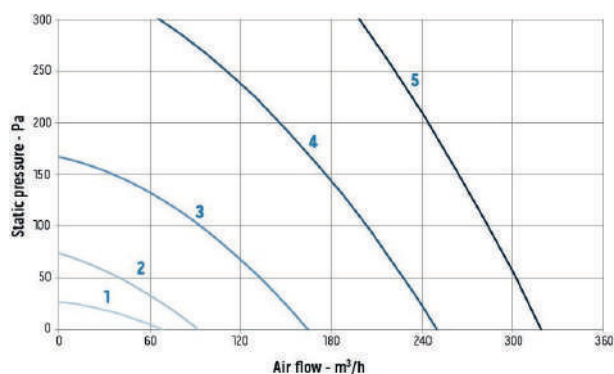

SITALI CXVA 280 S1

	Speed %	W max	m³/h
1	20	8	55
2	40	14	92
3	60	33	165
4	80	86	250
5	100	178	319

Input curves in accordance with European Regulation 1253/2014 (ErP)

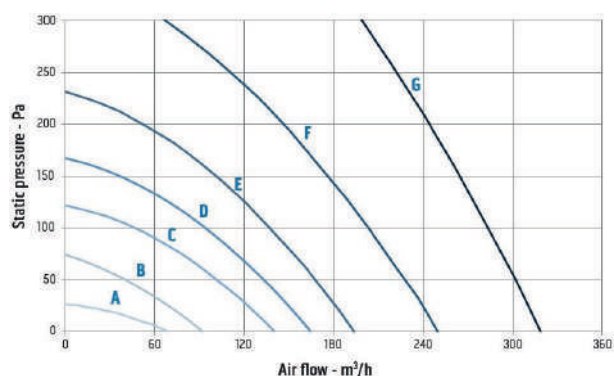

SITALI CXVM 280 S1

	Speed %	W max	m³/h max
1	20	8	55
2	40	14	92
3	53	21	143
4	60	33	165
5	70	41	197
6	80	86	250
7	100	178	319

Input curves in accordance with European Regulation 1253/2014 (ErP)

COMPATIBLE ACCESSORIES

CONTROLS	B1061	Control-S 2 recessed modules
	B1062	Control-S 3 recessed modules
	B1063	Wall-mounted control
EXTERNAL DISTRIBUTION	B1111	EPE 90 bend DN125
	B1074	Ø125mm wall passage
	B1104	Ø125mm telescopic pipe
	B1068	Flex ALU ISO Ø127mm
	B1066	Ø125mm ABS external grille
	B1113	EPE collar DN125
	B1112	EPE coupling DN125
	B1110	EPE pipe DN125 L=2m
INTERNAL DISTRIBUTION	B1058	E-1 design vent Ø80mm
	B1055	E-1 design vent Ø100mm
	B1056	E-1 design vent Ø125mm
	B1057	E-1 design vent Ø150mm
	B1070	FT-White grille 200x100mm

INTERNAL DISTRIBUTION	B1072	FT-White grille 300x100mm
	B1071	FT-Metal grille 200x100mm
	B1073	FT-Metal grille 300x100mm
	B1059	Flex HDPE 75/63
	B1054	FLEX HDPE 75/63 90° adaptor
	B1076	Blue HDPE 75/63 FLEX hooks
	B1077	Red HDPE 75/63 FLEX hooks
	B1078	FLEX HDPE 75/63 90° bend
	B1087	FLEX HDPE 75/63 coupling
	B1088	O-Ring FLEX HDPE 75/63
	B1095	Plenum P Ø125mm - 4 outlets (for Flex HDPE)
	B1096	Plenum P Ø125mm - 6 outlets (for Flex HDPE)
	B1094	Plenum P Ø125mm - 10 outlets (for Flex HDPE)
	B1092	Plenum L 200x100mm - 1 coupling (for Flex HDPE)
	B1093	Plenum L 300x100mm - 2 couplings (for Flex HDPE)
	B1101	Plenum P 200x100mm - 1 coupling (for Flex HDPE)

INTERNAL DISTRIBUTION	B1102	Plenum P 300x100mm - 2 couplings (for Flex HDPE)
	B1091	Plenum LCS 200x100mm - 1 coupling (for Flex HDPE)
	B1089	Plenum L 140x140mm - 1 coupling (for Flex HDPE)
	B1090	Plenum L 200x200mm - 2 couplings (for Flex HDPE)
	B1097	Plenum P 140x140mm - 1 coupling (for Flex HDPE)
	B1100	Plenum P 200x200mm - 2 couplings (for Flex HDPE)
	B1106	CAL80 damper
	B1107	METAL EST 125 valve
	B1108	PP EST-MM 125 valve
	B1109	METAL IMM 125 valve
FILTRATION	B1060	F7 filter box
	B1083	F7 filter
	B1084	G4 filter
B1207	M5 filter	

TECHNICAL DATA

		Sitali CXVM 280 S1	Sitali CXVA 280 S1
Product code		99204	99205
EAN code		8021183992458	8021183992465
Hole diameter	mm	125	125
Maximum flow rate @100 Pa	m³/h	270	270
Electrical power consumption (at the maximum flow rate)	W	170	170
SEC class (local demand control) (1)	(1)	A	A
SEC class (central demand control) (1)	(1)	A	A
SEC class (manual control - No demand control ventilation) (1)	(1)	B	B
Thermal efficiency	%	85	85
Reference flow rate	m³/h	189	189
Reference pressure difference	Pa	50	50
Specific power consumption (SPI)	W/m³/h	0,370	0,370
Sound power level (LWA)	dB(A)	57	57
Electrical power supply		220-240V/50-60Hz	220-240V/50-60Hz
IP protection rating		IPX2	IPX2
Sound pressure @3m (2)	(2) dB(A)	24	24
Room temperature (max)	°C	+40	+40

(1) Energy efficiency classes refer to a range between A+ and G.

(2) Sound pressure level at 3 m in free field, of the casing, speed 40%, reported for comparison purposes only.

HEAT RECOVERY VENTILATION UNIT

SITALI CX 400

Flow rate	363 m³/h
Type	ducted
Technology	cross-flow heat recovery
Installation	vertical



Integrated physical bypass

It allows for the heat exchanger to be partially bypassed during the summer, offering the possibility of using fresh outdoor air to cool the rooms ("free cooling").

Dual-flow heat recovery unit

Heat from the air extracted from inside the rooms is transferred to the fresh air supplied from outside, reducing the activation of the heating system and improving the building's energy performance.



- Air Replacement**
- Antifrost**
- Bypass**
- Holiday**
- Filter Cleaning Signal**
- Silent Mode**
- Turbo**

LAYOUT

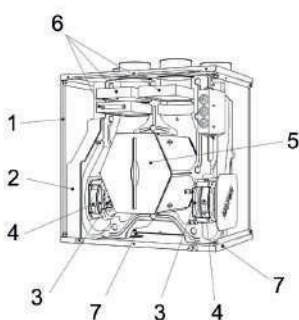

1. External panel in galvanised and pre-painted steel RAL 9010
2. Expanded polypropylene structure to reduce thermal bridges and sound emission, while ensuring maximum airtightness
3. Energy-efficient external rotor EC motors, equipped with thermal protection and mounted on ball bearings to ensure long life
4. Centrifugal-type fan with dynamically balanced backward-curved blades, coupled to the motor
5. High-efficiency cross-flow, counter-current heat exchanger
6. ISO Coarse 0% (G4) filters, removable from outside (no need to remove the access panel for maintenance)
7. Dual condensate drain, usable according to climatic requirements

DIMENSIONS AND WEIGHT

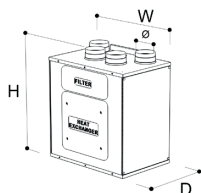

		400
W	mm	778
H	mm	860
D	mm	549
ø	mm	148
WEIGHT	kg	34,5

SUPPLY BENDS

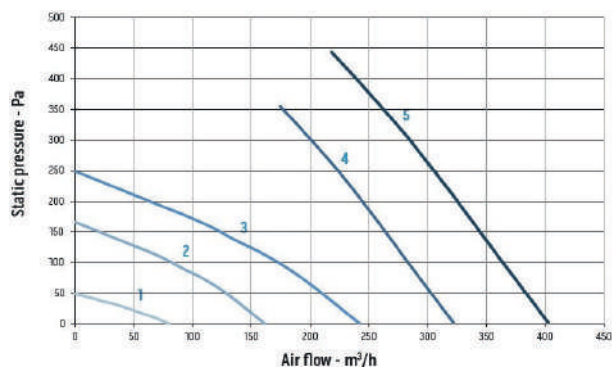

	Speed %	W max	m³/h max
1	20	10	84
2	40	22	162
3	60	48	243
4	80	90	322
5	100	160	403

Input curves in accordance with European Regulation 1253/2014 (ErP)

COMPATIBLE ACCESSORIES

EXTERNAL DISTRIBUTION	B1067	Ø150mm ABS external grille
	B1069	Flex ALU ISO Ø160mm
	B1075	Ø150mm wall passage
	B1105	Ø150mm telescopic pipe
	B1114	EPE pipe DN150 L=2m
	B1115	EPE 90 bend DN150
	B1116	EPE coupling DN150
INTERNAL DISTRIBUTION	B1117	EPE collar DN150
	B1058	E-I design vent Ø80mm
	B1055	E-I design vent Ø100mm
	B1056	E-I design vent Ø125mm
	B1057	E-I design vent Ø150mm
	B1070	FT-White grille 200x100mm
	B1072	FT-White grille 300x100mm

INTERNAL DISTRIBUTION	B1071	FT-Metal grille 200x100mm
	B1073	FT-Metal grille 300x100mm
	B1059	Flex HDPE 75/63
	B1054	FLEX HDPE 75/63 90° adaptor
	B1076	Blue HDPE 75/63 FLEX hooks
	B1077	Red HDPE 75/63 FLEX hooks
	B1078	FLEX HDPE 75/63 90° bend
	B1087	FLEX HDPE 75/63 coupling
	B1088	O-Ring FLEX HDPE 75/63
	B1098	Plenum P Ø150mm - 10 outlets (for Flex HDPE)
	B1099	Plenum P Ø150mm - 15 outlets (for Flex HDPE)
	B1092	Plenum L 200x100mm - 1 coupling (for Flex HDPE)
	B1093	Plenum L 300x100mm - 2 couplings (for Flex HDPE)
	B1101	Plenum P 200x100mm - 1 coupling (for Flex HDPE)

INTERNAL DISTRIBUTION	B1102	Plenum P 300x100mm - 2 couplings (for Flex HDPE)
	B1091	Plenum LCS 200x100mm - 1 coupling (for Flex HDPE)
	B1089	Plenum L 140x140mm - 1 coupling (for Flex HDPE)
	B1090	Plenum L 200x200mm - 2 couplings (for Flex HDPE)
	B1097	Plenum P 140x140mm - 1 coupling (for Flex HDPE)
	B1100	Plenum P 200x200mm - 2 couplings (for Flex HDPE)
	B1106	CAL80 damper
	B1107	METAL EST 125 valve
	B1108	PP EST-MM 125 valve
	B1109	METAL IMM 125 valve
FILTRATION	B1085	F7 filter
	B1086	G4 filter

TECHNICAL DATA

		Sitali CXVA 400
Product code		99244
EAN code		8021183992441
Hole diameter	mm	148
Maximum flow rate @100 Pa	m³/h	363
Electrical power consumption (at the maximum flow rate)	W	160
SEC class (local demand control) (1)	(1)	A+
SEC class (central demand control) (1)	(1)	A
SEC class (manual control - No demand control ventilation) (1)	(1)	A
Thermal efficiency	%	86
Reference flow rate	m³/h	254
Reference pressure difference	Pa	50
Specific power consumption (SPI)	W/m³/h	0,268
Sound power level (LWA)	dB(A)	52
Electrical power supply		220-240V~/50-60Hz
IP protection rating		IPX4
Sound pressure @3m (2)	(2) dB(A)	26
Room temperature (max)	°C	+40

(1) Energy efficiency classes refer to a range between A+ and G.

(2) Sound pressure level at 3 m in free field, of the casing, speed 40%, reported for comparison purposes only.

HEAT RECOVERY VENTILATION UNIT

SITALI CX 550

Flow rate	520 m³/h
Type	ducted
Technology	cross-flow heat recovery
Installation	vertical



Integrated physical bypass

It allows for the heat exchanger to be partially bypassed during the summer, offering the possibility of using fresh outdoor air to cool the rooms ("free cooling").

Dual-flow heat recovery unit

Heat from the air extracted from inside the rooms is transferred to the fresh air supplied from outside, reducing the activation of the heating system and improving the building's energy performance.



- Air Replacement**
- Antifrost**
- Bypass**
- Holiday**
- Filter Cleaning Signal**
- Silent Mode**
- Turbo**

LAYOUT

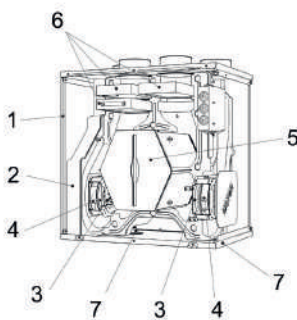

1. External panel in galvanised and pre-painted steel RAL 9010
2. Expanded polypropylene structure to reduce thermal bridges and sound emission, while ensuring maximum airtightness
3. Energy-efficient external rotor EC motors, equipped with thermal protection and mounted on ball bearings to ensure long life
4. Centrifugal-type fan with dynamically balanced backward-curved blades, coupled to the motor
5. High-efficiency cross-flow, counter-current heat exchanger
6. ISO Coarse 0% (G4) filters, removable from outside (no need to remove the access panel for maintenance)
7. Dual condensate drain, usable according to climatic requirements

DIMENSIONS AND WEIGHT

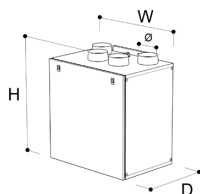

		550
W	mm	778
H	mm	860
D	mm	549
Ø	mm	148
WEIGHT	kg	44

SUPPLY BENDS

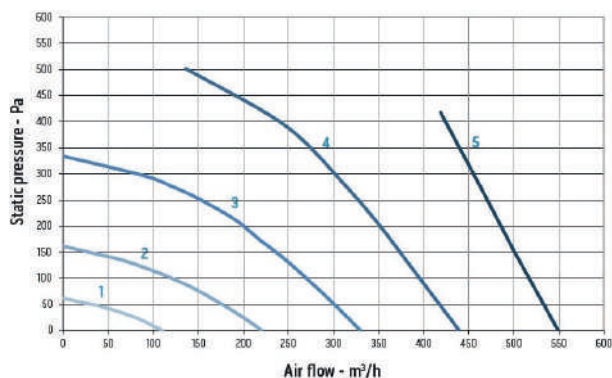

	Speed %	W max	m³/h max
1	20	17	110
2	40	44	221
3	60	110	330
4	80	264	440
5	100	333	550

Input curves in accordance with European Regulation 1253/2014 (ErP)

COMPATIBLE ACCESSORIES

EXTERNAL DISTRIBUTION	Code	Description
	B1067	Ø150mm ABS external grille
	B1069	Flex ALU ISO Ø160mm
	B1075	Ø150mm wall passage
	B1105	Ø150mm telescopic pipe
	B1114	EPE pipe DN150 L=2m
	B1115	EPE 90 bend DN150
	B1116	EPE coupling DN150
	B1117	EPE collar DN150
INTERNAL DISTRIBUTION		
	B1058	E-I design vent Ø80mm
	B1055	E-I design vent Ø100mm
	B1056	E-I design vent Ø125mm
	B1057	E-I design vent Ø150mm
	B1070	FT-White grille 200x100mm
	B1072	FT-White grille 300x100mm

INTERNAL DISTRIBUTION	Code	Description
	B1071	FT-Metal grille 200x100mm
	B1073	FT-Metal grille 300x100mm
	B1059	Flex HDPE 75/63
	B1054	FLEX HDPE 75/63 90° adaptor
	B1076	Blue HDPE 75/63 FLEX hooks
	B1077	Red HDPE 75/63 FLEX hooks
	B1078	FLEX HDPE 75/63 90° bend
	B1087	FLEX HDPE 75/63 coupling
	B1088	O-Ring FLEX HDPE 75/63
	B1098	Plenum P Ø150mm - 10 outlets (for Flex HDPE)
	B1099	Plenum P Ø150mm - 15 outlets (for Flex HDPE)
	B1092	Plenum L 200x100mm - 1 coupling (for Flex HDPE)
	B1093	Plenum L 300x100mm - 2 couplings (for Flex HDPE)
	B1011	Plenum P 200x100mm - 1 coupling (for Flex HDPE)

INTERNAL DISTRIBUTION	Code	Description
	B1102	Plenum P 300x100mm - 2 couplings (for Flex HDPE)
	B1091	Plenum LCS 200x100mm - 1 coupling (for Flex HDPE)
	B1089	Plenum L 140x140mm - 1 coupling (for Flex HDPE)
	B1090	Plenum P 200x200mm - 2 couplings (for Flex HDPE)
	B1097	Plenum P 140x140mm - 1 coupling (for Flex HDPE)
	B1100	Plenum P 200x200mm - 2 couplings (for Flex HDPE)
	B1106	CAL80 damper
	B1107	METAL EST 125 valve
	B1108	PP EST-MM 125 valve
	B1109	METAL IMM 125 valve
FILTRATION		
	B1085	F7 filter
	B1086	G4 filter

TECHNICAL DATA

		Sitali CXVA 550
Product code		99243
EAN code		8021183992434
Hole diameter	mm	148
Maximum flow rate @100 Pa	m³/h	520
Electrical power consumption (at the maximum flow rate)	W	333
SEC class (local demand control) (1)	(1)	A
SEC class (central demand control) (1)	(1)	A
SEC class (manual control - No demand control ventilation) (1)	(1)	B
Thermal efficiency	%	82
Reference flow rate	m³/h	364
Reference pressure difference	Pa	50
Specific power consumption (SPI)	W/m³/h	0,412
Sound power level (LWA)	dB(A)	58
Electrical power supply		220-240V~/50-60Hz
IP protection rating		IPX4
Sound pressure @3m (2)	(2) dB(A)	34
Room temperature (max)	°C	+40

Energy efficiency classes refer to a range between A+ and G.

Accessories

Controls

B1061

Control-S 2 recessed modules

Remote control for HRV unit with heat recovery, equipped with 3 switches. Option to select 3 speeds and enable free-cooling mode. 230V~ 50/60Hz.



B1062

Control-S 3 recessed modules

Remote control for HRV unit with heat recovery, equipped with 3 switches. Option to select 3 speeds and enable free-cooling mode. 230V~ 50/60Hz. Version for recessed installation with 3 modules suitable for box 503.



B1063

Wall-mounted control

Remote control for HRV unit with heat recovery, equipped with 3 switches. Option to select 3 speeds and enable free-cooling mode. 230V~ 50/60Hz.



Outdoor air distribution kit

B0838

External grille

High-quality ABS fixed external grille, resistant to impacts and UV rays. Colour RAL 9010. 100mm diameter.



B0837

Telescopic pipe

PVC telescopic pipe which adapts to the thickness of the wall. 100mm diameter.



B1119

Terminal unit 150 Silent

External terminal unit with very high sound absorption (sound reduction index Dnew 45dB), designed to reduce noise coming from outside. Suitable for particularly windy outdoor conditions. Made of pre-painted RAL9010 aluminium sheet, equipped with a fireproof sound-absorbing mat, front inspection panel, drip tray and insect mesh. Possibility of semi-recessed installation as well.



B1065

Ø100mm ABS external grille

High-quality ABS fixed external grille, resistant to impacts and UV rays. Colour RAL 9010.



B1066

Ø125mm ABS external grille

High-quality ABS fixed external grille, resistant to impacts and UV rays. Colour RAL 9010.



B1067

Ø150mm ABS external grille

High-quality ABS fixed external grille, resistant to impacts and UV rays. Colour RAL 9010.



Outdoor air distribution kit

B1068	Flex ALU ISO Ø127mm	Flexible pipe, 10m in length, made with aluminium/polyester/micro-perforated aluminium walls for air passage noise reduction and steel concertina wire. Polyester fibre thermal insulation coating (thickness 25mm/16kg/m ³) and aluminium-coated polyolefin film outer protection	
B1069	Flex ALU ISO Ø160mm	Flexible pipe, 10m in length, made with aluminium/polyester/micro-perforated aluminium walls for air passage noise reduction and steel concertina wire. Polyester fibre thermal insulation coating (thickness 25mm/16kg/m ³) and aluminium-coated polyolefin film outer protection	
B1074	Ø125mm wall passage	Wall penetration kit with external terminal in galvanised sheet metal coated in RAL 9010 and fitted with sound-absorbing mat.	
B1075	Ø150mm wall passage	Wall penetration kit with external terminal in galvanised sheet metal coated in RAL 9010 and fitted with sound-absorbing mat.	
B1103	Ø100mm telescopic pipe	PVC telescopic pipes which adapt to the thickness of the wall. (L=300-570 mm).	
B1104	Ø125mm telescopic pipe	PVC telescopic pipes which adapt to the thickness of the wall. (L=300-570 mm).	
B1105	Ø150mm telescopic pipe	PVC telescopic pipes which adapt to the thickness of the wall. (L=300-570 mm).	
B1110	EPE pipe DN125 L=2m	Insulated and soundproofed EPE pipe, with smooth interior and exterior; length 2m.	
B1114	EPE pipe DN150 L=2m	Insulated and soundproofed EPE pipe, with smooth interior and exterior; length 2m.	
B1111	EPE 90 bend DN125	Insulated and soundproofed EPE bend, with smooth interior and exterior.	

Accessories

Outdoor air distribution kit

B1115	<p>EPE 90 bend DN150 Insulated and soundproofed EPE bend, with smooth interior and exterior.</p>	
B1112	<p>EPE coupling DN125 Coupling for EPE duct/EPE duct, EPE duct/EPE 90 bend connection.</p>	
B1116	<p>EPE coupling DN150 Coupling for EPE duct/EPE duct, EPE duct/EPE 90 bend connection.</p>	
B1113	<p>EPE collar DN125 Bracket collar for connection between the EPE duct/fan unit and the EPE duct/distribution plenum.</p>	
B1117	<p>EPE collar DN150 Bracket collar for connection between the EPE duct/fan unit and the EPE duct/distribution plenum.</p>	

Internal air distribution kit

B1058	<p>E-I design vent Ø80mm Extraction/inlet vent with flow rate adjustment module; front cover made of high-quality ABS; white RAL 9010. The adjustment module consists of removable concentric rings to define the desired air volume.</p>	
B1055	<p>E-I design vent Ø100mm Extraction/inlet vent with flow rate adjustment module; front cover made of high-quality ABS; white RAL 9010. The adjustment module consists of removable concentric rings to define the desired air volume.</p>	
B1056	<p>E-I design vent Ø125mm Extraction/inlet vent with flow rate adjustment module; front cover made of high-quality ABS; white RAL 9010. The adjustment module consists of removable concentric rings to define the desired air volume.</p>	
B1057	<p>E-I design vent Ø150mm Extraction/inlet vent with flow rate adjustment module; front cover made of high-quality ABS; white RAL 9010. The adjustment module consists of removable concentric rings to define the desired air volume.</p>	

Internal air distribution kit

B1070	FT-White grille 200x100mm Rectangular steel grille pre-painted white RAL 9010, with round perforated screen and magnetic attachment system.	
B1072	FT-White grille 300x100mm Rectangular steel grille pre-painted white RAL 9010, with round perforated screen and magnetic attachment system.	
B1071	FT-Metal grille 200x100mm Rectangular steel grille with metallic finish, round perforated screen and magnetic attachment system.	
B1073	FT-Metal grille 300x100mm Rectangular steel grille with metallic finish, round perforated screen and magnetic attachment system.	
B1059	Flex HDPE 75/63 Flexible 75/63 pipe with antimicrobial, antibacterial and antistatic treatment, made with high-density double polyethylene wall; corrugated on the outside and smooth on the inside; supplied with end caps; used to channel the air from the distribution plenums to the air inlet and extraction vents. Suitable for installation in concrete slab, false ceilings or on walls. Length 50 m.	
B1054	FLEX HDPE 75/63 90° adaptor 90° angle adaptor, Ø125mm with 2 x Ø80mm connections (for Flex HDPE 75/63 duct), including 2 protection/end caps, length 250mm. Suitable for 125mm diameter design vents and extraction/inlet valves.	
B1076	Blue HDPE 75/63 FLEX hooks Connection kit for Flex HDPE 75/63 duct, to make on-site installation easier. Available in packs of 12.	
B1077	Red HDPE 75/63 FLEX hooks Connection kit for Flex HDPE 75/63 duct, to make on-site installation easier. Available in packs of 12.	
B1078	FLEX HDPE 75/63 90° bend 90° bend kit for Flex HDPE 75/63 duct, with sealing rings included.	
B1087	FLEX HDPE 75/63 coupling Coupling kit for Flex HDPE 75/63 duct with sealing rings included.	

Accessories

Internal air distribution kit

B1088 **O-Ring FLEX HDPE 75/63**
O-ring kit for Flex HDPE 75/63 duct (pack of 10).



B1095 **Plenum P Ø125mm - 4 outlets (for Flex HDPE)**
Distribution plenum, 1 inlet Ø125mm, 4 outlets Ø80mm (for Flex HDPE 75/63 duct) and 5 protection/end caps supplied.



B1096 **Plenum P Ø125mm - 6 outlets (for Flex HDPE)**
Distribution plenum, 1 inlet Ø125mm, 6 outlets Ø80mm (for Flex HDPE 75/63 duct) and 7 protection/end caps supplied.



B1094 **Plenum P Ø125mm - 10 outlets (for Flex HDPE)**
Distribution plenum, 1 inlet Ø125mm, 10 outlets Ø80mm (for Flex HDPE 75/63 duct) and 11 protection/end caps supplied.



B1098 **Plenum P Ø150mm - 10 outlets (for Flex HDPE)**
Distribution plenum, 1 inlet Ø150mm, 10 outlets Ø80mm (for Flex HDPE 75/63 duct) and 11 protection/end caps supplied.



B1099 **Plenum P Ø150mm - 15 outlets (for Flex HDPE)**
Distribution plenum, 1 inlet Ø150mm, 15 outlets Ø80mm (for Flex HDPE 75/63 duct) and 16 protection/end caps supplied.



B1092 **Plenum L 200x100mm - 1 coupling (for Flex HDPE)**
Inlet/extraction plenum, 1 connection on the long side Ø80mm, complete with anti-mortar closure and 1 cap (for Flex HDPE 75/63 duct). Air flow adjustment via the CAL80 damper (on request).



B1093 **Plenum L 300x100mm - 2 couplings (for Flex HDPE)**
Inlet/extraction plenum, 2 connections on the long side Ø80mm, complete with anti-mortar closure and 2 caps (for Flex HDPE 75/63 duct). Air flow adjustment via the CAL80 damper (on request).



B1101 **Plenum P 200x100mm - 1 coupling (for Flex HDPE)**
Inlet/extraction plenum, 1 rear connection Ø80mm, complete with anti-mortar closure and 1 cap (for Flex HDPE 75/63 duct). Air flow adjustment via the CAL80 damper (on request).



B1102 **Plenum P 300x100mm - 2 couplings (for Flex HDPE)**
Inlet/extraction plenum, 2 rear connections Ø80mm, complete with anti-mortar closure and 2 caps (for Flex HDPE 75/63 duct). Air flow adjustment via the CAL80 damper (on request).



Internal air distribution kit

B1091	<p>Plenum LCS 200x100mm - 1 coupling (for Flex HDPE) Inlet/extraction plenum, 1 connection on the short side Ø80mm, complete with anti-mortar closure and 1 cap (for Flex HDPE 75/63 duct).</p>	
B1089	<p>Plenum L 140x140mm - 1 coupling (for Flex HDPE) Inlet/extraction plenum with 1 side connection Ø80mm (for HDPE 75/63). Including anti-mortar closure and 1 protection/end cap. Dimension 140x140mm. Suitable for 80 and 100mm diameter design vents.</p>	
B1090	<p>Plenum L 200x200mm - 2 couplings (for Flex HDPE) Inlet/extraction plenum with 2 side connections Ø80mm (for HDPE 75/63). Including anti-mortar closure and 2 protection/end caps. Dimension 200x200mm. Suitable for 125 and 150mm diameter design vents.</p>	
B1097	<p>Plenum P 140x140mm - 1 coupling (for Flex HDPE) Inlet/extraction plenum with 1 rear connection Ø80mm (for HDPE 75/63). Including anti-mortar closure and 1 protection/end cap. Suitable for 80 and 100mm diameter design vents.</p>	
B1100	<p>Plenum P 200x200mm - 2 couplings (for Flex HDPE) Inlet/extraction plenum with 2 rear connections Ø80mm (for HDPE 75/63). Including anti-mortar closure and 2 protection/end caps. Suitable for 125 and 150mm diameter design vents.</p>	
B1106	<p>CAL80 damper Flow rate regulator damper, designed to be attached to the vents Ø80mm of the inlet/extraction plenum or distribution plenum, made of polypropylene, with quick-fit system, including wing-shaped fins to ensure maximum acoustic comfort. Pack of 3</p>	
B1107	<p>METAL EST 125 valve RAL 9010 painted steel exhaust valve, Ø125mm, manually and progressively adjustable</p>	
B1108	<p>PP EST-MM 125 valve White PP supply/exhaust valve, Ø125mm, manually and progressively adjustable</p>	
B1109	<p>METAL IMM 125 valve RAL 9010 painted steel supply valve, Ø125mm, manually and progressively adjustable.</p>	

Accessories

Filters Kit

B1060 **F7 filter box**
 External box complete with F7 filter, with pre-painted galvanised sheet metal structure RAL 9010 and 125mm diameter connection.



B1079 **F7 filter**
 Class F7 filtration elements for Sitali CX 120 (pack of 1).



B1081 **F7 filter**
 Class F7 filtration elements for Sitali CX 180 (pack of 1).



B1083 **F7 filter**
 Class F7 filtration elements for Sitali CX 280 (pack of 1).



B1085 **F7 filter**
 Class F7 filtration elements for Sitali CX 400 and 550 (pack of 1).



B1080 **G4 filter**
 Class G4 filtration element for Sitali CX 120 (pack of 2).



B1082 **G4 filter**
 Class G4 filtration element for Sitali CX 180 (pack of 2).



B1084 **G4 filter**
 Class G4 filtration element for Sitali CX 280 (pack of 2).



B1086 **G4 filter**
 Class G4 filtration element for Sitali CX 400 and 550 (pack of 2).



B1207 **M5 filter**
 Class M5 filtration element (pack of 2).





UNICO

NEXVA

SHERPA

BIZ

SITALI

SIOS CONTROL

DOLCECLIMA

AQUARIA